

直角风幕展示柜 RECTANGULAR REFRIGERATED MULTIDECKS SHOWCASE

产品特点 General Features

- 两侧为双层超白钢化玻璃
 - 高透PE材质, 伸缩微孔夜幕拉帘
 - LED灯光照明
 - 自动除霜
 - 可上下调节不锈钢层架
 - 加固万向脚轮, 移动更方便
 - 材质采用不锈钢
 - 风冷制冷系统
 - 高密度发泡箱体
 - 欧洲品牌温控器
 - 欧洲品牌压缩机
- Both sides are made of double layered ultra white tempered glass
 - High permeability PE material, telescopic microporous night curtain
 - LED lighting
 - Automatic defrosting
 - Stainless steel layer frame can be adjusted up and down
 - Reinforced universal casters for easier movement
 - Stainless steel structure
 - Ventilated cooling system
 - High density insulation body
 - Europe brand controller
 - European brand compressor

产品细节 Product Details



1. 欧洲品牌温控器
 2. LED灯光照明
 3. 伸缩微孔夜幕拉帘
 4. 可上下调节不锈钢层架
 5. 网孔不锈钢板
 6. 各层冷风孔
1. Europe brand controller
 2. LED lighting
 3. Telescopic microporous night curtain
 4. Stainless steel layer frame can be adjusted up and down
 5. Mesh stainless steel plate
 6. Cold air holes on each floor

产品参数 Technical Data

型号 Model	AC900
产品尺寸 Product Size (mm)	895 × 775 × 1900
温度范围 Temperature (°C)	+2~+8
赫兹 Hz	50
额定电压 Rated voltage (V)	220
额定功率 Power (W)	551
电流 Electric Current(A)	2.8
净重 Net Weight (Kg)	165
气候类型 Climate type	T
制冷剂容量 Refrigerant (g)	R290/130

产品认证 Product Certification



* 我司有权利更改产品设计和配置, 不会提前告知客户! We have the right to change the product design and configuration without informing customers in advance!



面板油漆涂料选用国际标准色卡
International Standard Color Card
for Panel Paint and Coatings



平面图
Plan View

正视图 Front View

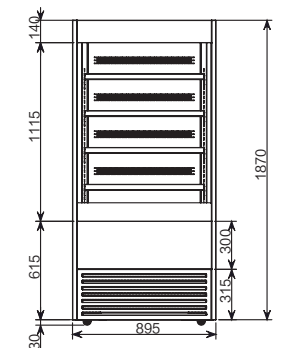

侧视图 Side View

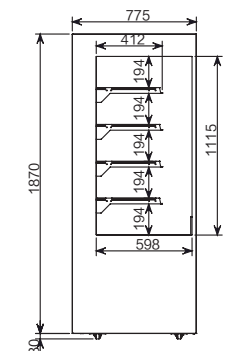

俯视图 Vertical View

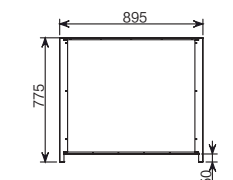

优质不锈钢面板
High quality stainless steel panel

- 乱纹不锈钢
Random pattern stainless steel
- 银色拉丝不锈钢
Silver stainless steel
- 黑色拉丝不锈钢
Black stainless steel
- 白镜面不锈钢
White mirror stainless steel
- 黑镜面不锈钢
Black mirror stainless steel

